



ACS SERIES

CLOSE-COUPLED CENTRIFUGAL

ACS2



The ARCTIC ACS Series of centrifugal pumps are designed for continuous duty performance. The Pumps are manufactured in welded 304 Stainless Steel for reduced corrosion and - as a standard - are fitted with a ceramic/carbon graphite/nitrile mechanical seal.

They are single stage end suction centrifugal pumps close coupled to NEMA standard motors with enclosed impellers for maximum efficiencies.

Motors are NEMA 56J industry standard and are available in ODP, TEFC and Explosion-Proof enclosures.

Applications:

- Water Circulation
- Liquid Transfer
- Spray Systems
- Washing / Cleaning
- Filtration Systems
- Chiller Systems

Pump Features:

| | |
|---------------------------------|-------------------------------------|
| Size..... | 1.50" x 1.25" (suction x discharge) |
| Inlet & Outlet Connections..... | NPT |
| Flow Rate..... | 107 usgpm max. |
| Pressure..... | 48 psi max. |
| Pump Metallurgy..... | 304 Stainless Steel |
| Impeller Type..... | Enclosed |
| Impeller Diameter..... | 5.4" max. |
| Standard Mechanical Seal..... | Ceramic / Carbon Graphite / Nitrile |

Motor Features:

| | |
|-------------------------------|---------------------------------|
| Horsepower Range..... | 1.5 hp to 5.0 hp |
| Enclosures Available..... | ODP, TEFC, Explosion Proof |
| Hertz..... | 60 |
| Speed..... | 3500 RPM |
| Motor Voltages Available..... | 1 phase 230 V |
| | 1 phase 115 / 230 V |
| | 3 phase 208 - 230 / 460 V |
| | 3 phase 575 V |

Arctic Industrial Solutions

Phone: 905.602.1577 • 1.877.567.7480

Fax: 905.602.0315 • 1.877.363.2004

Email: sales@arctic-industrial.com

www.arctic-industrial.com

DIMENSIONAL DRAWING

ACS2 with 1 PHASE 56J 3500 RPM TEFC MOTOR

DIMENSIONS ARE APPROXIMATE

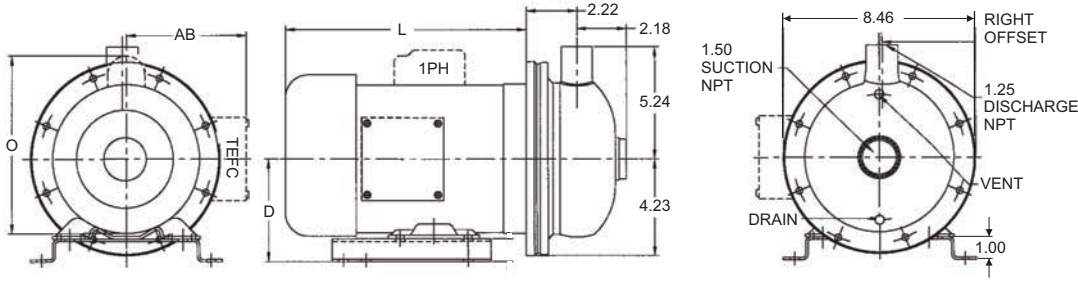

MOTOR DIMENSIONS

NEMA 56J FRAME

3500 RPM

ALL DIMENSIONS ARE IN INCHES
 PUMPS MUST ONLY BE INSTALLED
 IN THE HORIZONTAL POSITION
 5.0 HP MOTOR DETAILS ARE
 AVAILABLE ON REQUEST

| HP | FRAME | TYPE | 1PH | | | | 3PH | | | |
|-----|-------|------|-------|------|------|------|-------|------|------|------|
| | | | L | O | D | AB | L | O | D | AB |
| 1.5 | 56J | ODP | 8.87 | 8.00 | 3.50 | 3.25 | 8.87 | 6.50 | 3.50 | 3.25 |
| 3.0 | 56J | ODP | 9.37 | 8.00 | 3.50 | 3.25 | 9.37 | 6.50 | 3.50 | 3.25 |
| 1.5 | 56J | TEFC | 13.18 | 8.13 | 4.50 | 5.31 | 9.43 | 7.04 | 4.50 | 5.31 |
| 3.0 | 56J | TEFC | 14.75 | 8.13 | 4.50 | 5.31 | 11.30 | 7.04 | 4.50 | 5.31 |

ACS2

PUMP SIZE (Inlet x Outlet x Max. Impeller Diameter): 1.50" x 1.25" x 5.4"
 IMPELLER TYPE: Enclosed

